

WARNING!

Ski mountaineering is an exceptionally hazardous activity which often results in severe injuries and death. Any person purchasing or using this equipment assumes the responsibility for seeking proper training in its use and also assumes all risk for injury or damage sustained while using any of this equipment. This equipment is not to be used for any other purpose other than what it is intended for. Failure to follow these warnings increase the risk of injury or death. B & D Precision is not or shall not be liable for direct, indirect, incidental or other types of damages arising out of, or resulting from the use of this product.

Mounting should only be attempted by a qualified person with an understanding of how ski crampons function, and who is skilled with tools.

Installing Mount Blocks

The Outlaw crampon uses 2 mount blocks per crampon. This can make mounting more challenging than other crampon systems.

Tools needed :

- 1.-7/64 drill bit (.109", 2.8mm)
- 2.-Power Drill
- 3.-Tape
4. Flat head & phillips screwdrivers
- 5.-Round file 7/32"-15/64" (5.5-6 mm) dia- this is just in case alignment is not good enough.

First check that binding is mounted straight and in center of the ski. If not, you may need to adjust plastic template to make sure it will be in center of the ski and parallel with ski.

Position template against base of binding (it hooks around). It's best to tape it in place. Double sided tape works great for this.

Screws stick out of mount 5/16"(8mm), so set stop on drill to 3/8"(9.5mm). Drill thru template into ski, making sure template stays still. Pin first hole in place before drilling the other holes.

To install screws, first slide mounts onto crampon. To help space mounts more accurately, slip pieces of paper in between mounts and crampon slots. Place mounts over holes and install 4 screws. If crampon binds, use round file to loosen. Repeat for 2nd ski.

Using the flat head screws from underneath, install black plates on top of the crampon. For large binding, use front holes; for small binding use rear holes to shift block forward.

Installing Crampon

Slide crampon into mount block from right side with crampon in a position 90 degrees from horizontal. Holding crampon close to pivot pin will help provide easy entry and installation. Stop will limit travel to operating position. Allow crampon to rotate down to horizontal position which locks it in position.

Make sure crampon is allowed to drop down parallel to ski prior to applying pressure with boot. This will avoid damage to base and crampon.

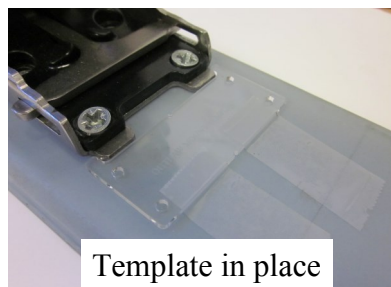

Template in place

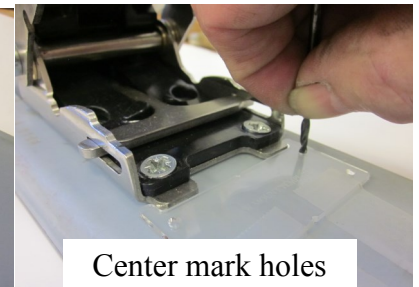

Center mark holes



Set drill length

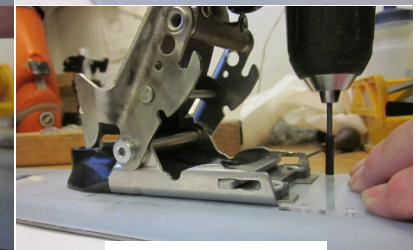

Drilling holes

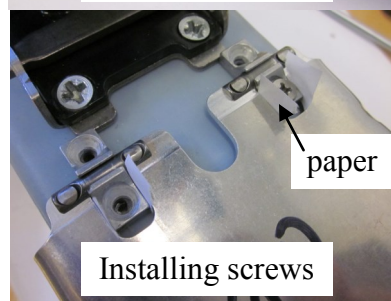

paper

Installing screws

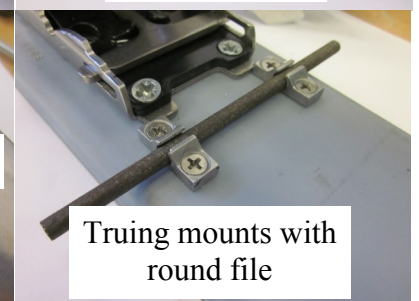

Truing mounts with round file

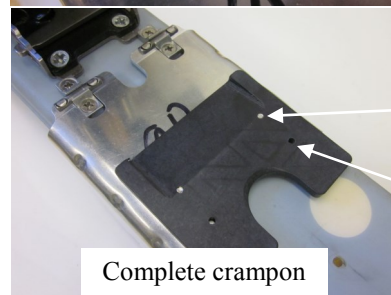

Complete crampon

Large Binding Holes

Small Binding Holes

Questions regarding installation and operation, and any suggestions may be addressed to:

sales@bndskigear.com

B&D Ski Crampons are approved by 22 Designs for use with Outlaw Bindings under warranty.

